

ITEM NO.	PART NUMBER	Description	Material	StockSize	QTY.
1	DSS-C1600-101R	End Frame, RH	See BOM	See BOM	1
2	DSS-C1600-101L	End Frame, LH	See BOM	See BOM	1
3	DSS-C1600-102	Spray Bar Sleeve Weldment	See BOM	See BOM	1
4	DSS-C1600-103R	Rubber Skirt UA, RH	See BOM	See BOM	1
5	DSS-C1600-103L	Rubber Skirt UA, LH	See BOM	See BOM	1
6	DSS-C1600-104R	Front EA	See BOM	See BOM	1
7	DSS-C1600-104L	Back EA	EA100 x 10 - AS/NSZ 3679.1-300	1980 mm	1
8	DSS-C1600-105M	Cover, Middle Section	3 PL - AS/NSZ 3678-300	2180 x 674 mm	1
9	DSS-C1600-105L	Cover, Left Hand Section	3 PL - AS/NSZ 3678-300	2180 x 1098 mm	1
10	DSS-C1600-105R	Cover, Right Hand Section	3 PL - AS/NSZ 3678-300	2180 x 371 mm	1
11	DSS-C1600-106	Spray Arm	See BOM	See BOM	1
12	DSS-C1600-107	Handle	See BOM	See BOM	1
13	DSS-C1600-108	Pin	20 RB - AS/NSZ 3678-250	See BOM	1
14	DSS-C1600-109	Spray Arm Stop EA	SEE bom	See BOM	1
15	DSS-C1600-114	Bracket #1	10 PL - AS/NSZ 3678-250	468 x 269	2
16	DSS-C1600-121	Mesh Door	3PL - AS/NZS 3678-250	967 x 619 mm	2
17	DSS-C1600-122	Mesh Door, L1990mm	5PL - AS/NZS 3678-250	860 x 860 mm	1
18	AS-NZS 1252 - 16	Plain Washer	Grade 8.8	A16	84
19	AS-NZS 1252 - M16 x 70-N	High Strength Hex Head Bolt	Grade 8.8	M16 x 70	42
20	AS-NZS 1252 NS - M16-W-N	Hex Nut	Grade 8.8	M16	42
22	AS 1237.1 N - 8	Plain Washer	Grade 8.8	M8	62
23	AS 1111.2 - M8 x 25-WN	Hex Head Bolt	Grade 8.8	M8 x 25	31
24	AS 1112.3 C- M8-N	Hex Nut	Grade 8.8	M8	31

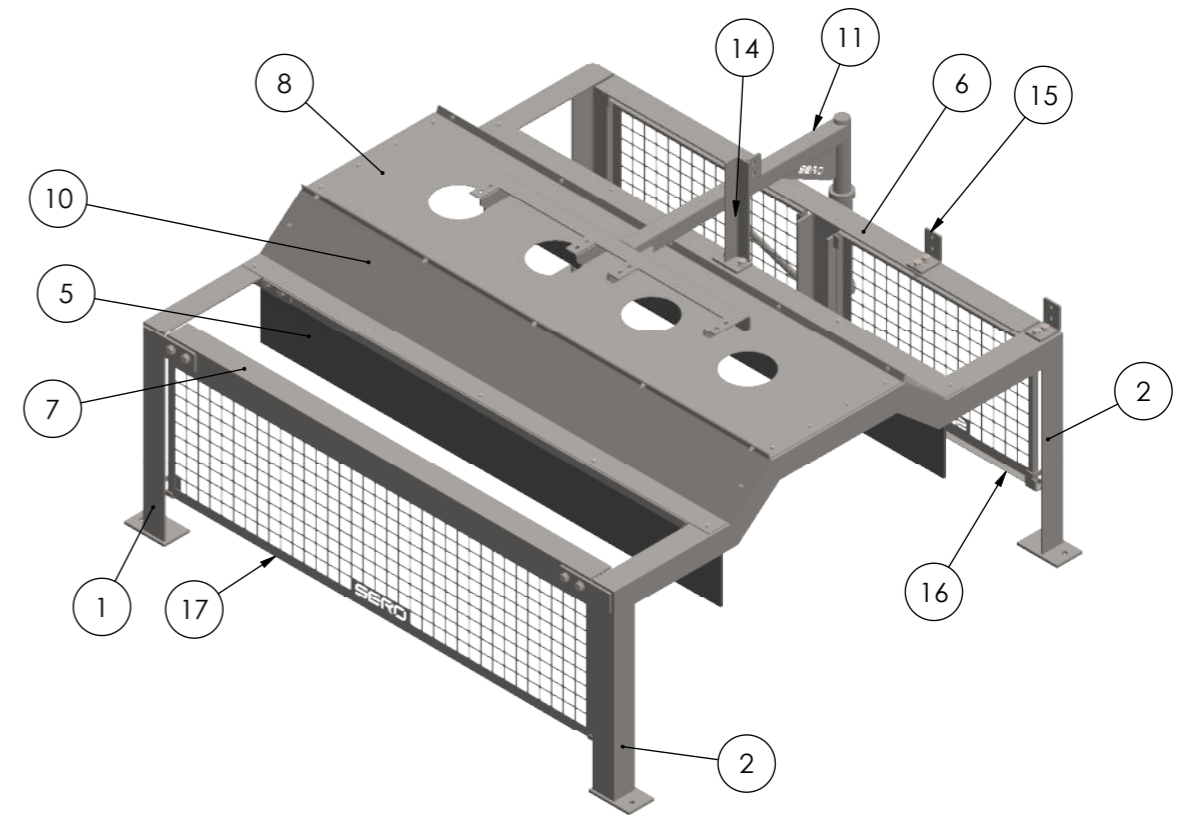

NOTES:

- 1 - DESIGN CODE : AS3990, AS1657
- 2 - WELDS : Min 6MM FILLET TO AS1554.1
- 3 - BOLTS : CLASS 8.8 (AS1100)
- 4 - NUTS : CLASS 8 (AS1112)
- 5 - RAW MATERIAL :
 - PLATES : GRADE 300 (AS3678)
 - Hot-Rolled Steel Section : GRADE 350 (AS3679)
 - Cold Formed Steel Hollow Section: Grade 300 (AS1163)
- 6 - ALL SHARP EDGES TO BE REMOVED
- 7 - HOT DIP GALVANIZED

FABRICATED BY	DATE
FABRICATION CHECK BY	DATE
WELD CHECK BY	DATE

0	14/11/2022	ISSUE FOR REVIEW	MO	MM
REV	DATE	DESCRIPTION	DRN	CHK

Ore Dust Suppression Spray

DRAWING TITLE	Ore Dust Suppression Spray, C1600			
CONTRACT				
MODELLED BY	HE	CHECKED BY	MO	
SHEET NO.	1 OF 2	DRAWING NO.	REVISION	
SCALE	1:50	DSS-C1600-100	0	



GENERAL NOTE

ALL STEELWORK TO BE FABRICATED & ERECTED TO AS4100
 ALL WELDS TO BE 6MM C.F.W- U.N.O.
 ALL WELDING TO AS1554
 ALL CLEATS TO BE ON CENTERLINE U.N.O
 HARDSTAMP ASSEMBLY MARK WHERE INDICATED THUS
 ALL SNIPES ARE 15x45°